



Air seal against PEF backing rod installed by builder

Slab must be sealed by the builder using a suitable waterproofing membrane prior to the installation of the joinery. The membrane must seal the entire sill area and 100mm up the jamb frame

Removeable channel cover by others

Channel cover support brackets by others

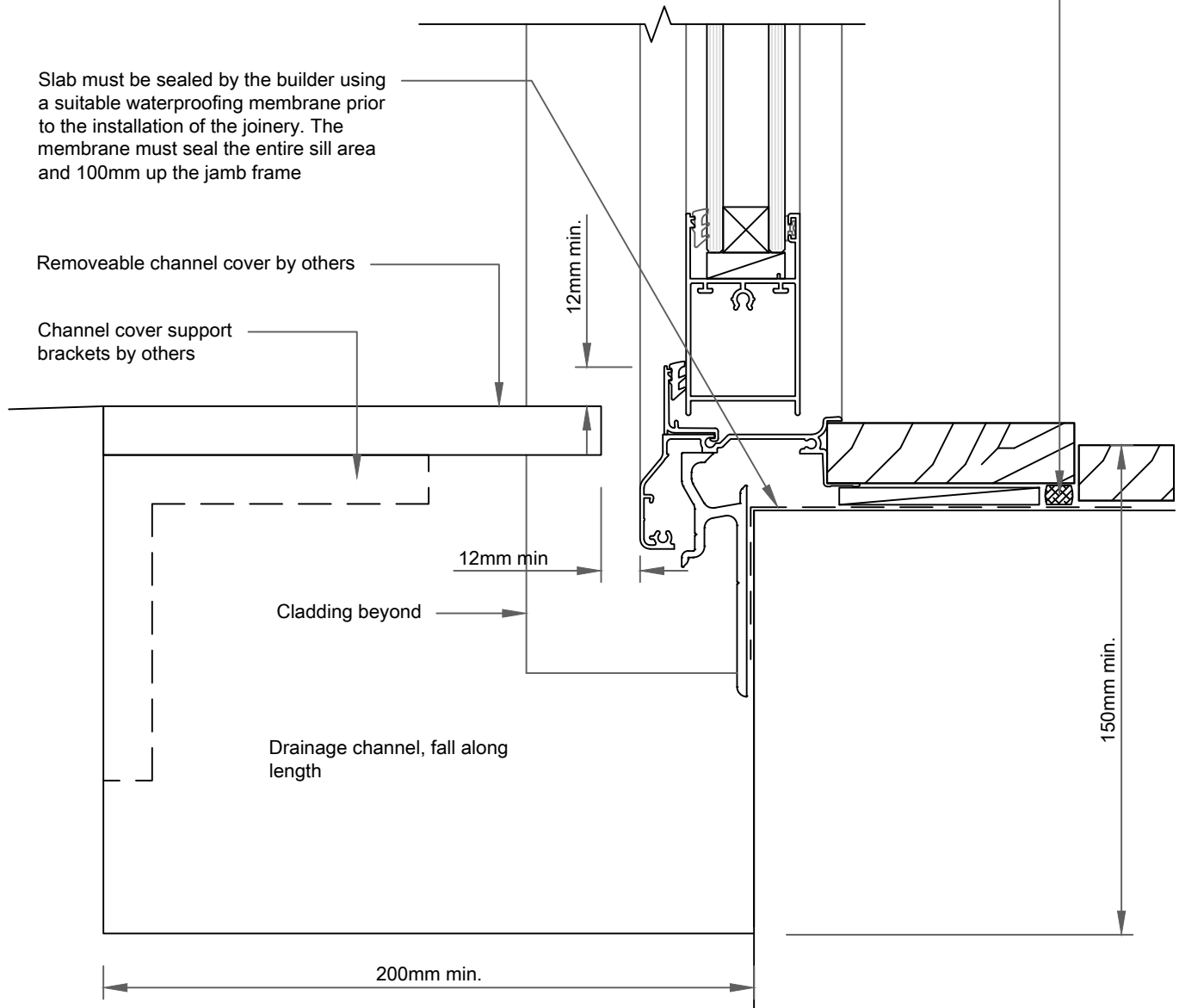

Where provision for level access is required from a concrete floor slab to exterior paving this shall be as shown in Figure 17B with:

A channel, together with drainage provisions, accross the door opening, with:

- the width to suit capacity in accordance with E1/AS1
- a minimum depth of 150mm,
- a maximum length of 3700mm, and
- 1:200 minimum fall along length of channel towards a drainage outlet

**09D**

**DOOR SILL - LEVEL THRESHOLD**

SCALE: 1:2

**EZPANEL**